

CERTIFIED LAND CORNER RECORDATION

DESCRIPTION OF CORNER EVIDENCE FOUND, AND ORIGINAL RECORD (if known)

LOCATION No evidence of corner found.
 Corner re-established by single proportionate measurement.
 $\frac{1}{4}$
 S.33 S.34 G.L.O. record - Granite Boulder, 16 x 7 x 6 (1870).
 T.15N., R.67W.
 6th P.M.

DESCRIPTION OF MONUMENT AND ACCESSORIES ESTABLISHED
 TO PERPETUATE THE ORIGINAL LOCATION OF THIS CORNER:

At the corner: Set a 1 $\frac{1}{2}$ " dia. x 30" long iron pipe with brass cap.
 Accessories: None

SKETCH, WITH COURSE AND DISTANCE TO ADJACENT CORNER IF DETERMINED IN THIS SURVEY.
 (May Sketch or Paste Reproduction on Reverse Side.)

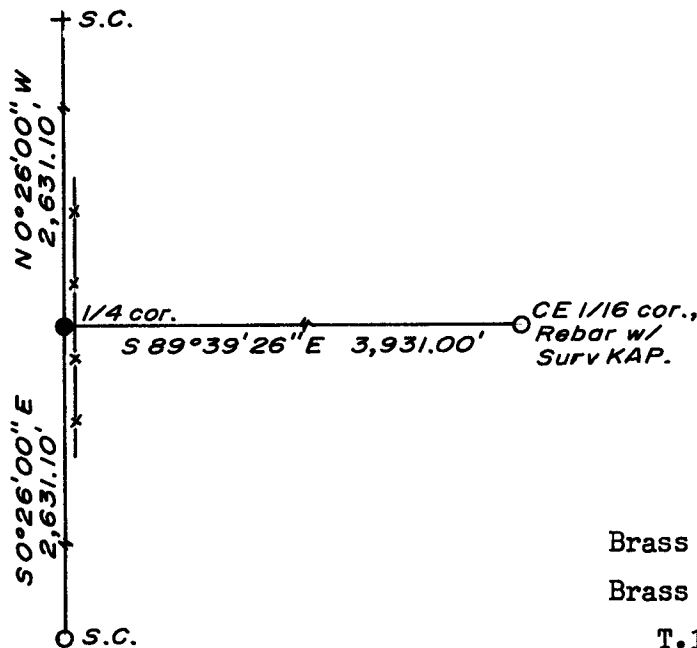

Brass cap set 4" above ground.
 Brass cap stamped:
 T.15N. R.67W.
 $\frac{1}{4}$
 S.33 S.34
 LS 519 1974

Basis of Bearing - By solar observation.

I, R.L. Hudson certify that I have carefully performed or reviewed the work done on the diagrammed corner as reported on this recordation form and approve the same.

R.L. Hudson
 Signature of Surveyor

Wyoming L.S. No. 519
 Registration No.

STATE OF WYOMING,
 Office of Clerk and Recorder,
 County of Taramie

This "corner record" was filed for record on the 24 day of June, 1974, was noted on the cross-index plat and is assigned page No. _____, in book No. _____.

John B. Heisman
 County Official

Cross Index No. X13 T. 15 R. 67 Mer. 6
 _____ T. _____ R. _____ Mer. _____
 _____ T. _____ R. _____ Mer. _____
 _____ T. _____ R. _____ Mer. _____
 _____ T. _____ R. _____ Mer. _____
 _____ T. _____ R. _____ Mer. _____
 _____ T. _____ R. _____ Mer. _____

Photographed
Indexed
Posted
Assessor

The State of Wyoming }
County of Laramie } ss

This instrument was filed for record
at 10⁵³ o'clock 4 M. on the

34 day of June
A. D. 19 24 and duly recorded in

Book _____ on page _____

John B. Williams

County Clerk & Ex-Officio Registrar of Deeds
By J.B. Deputy